

HUDSON HOUSE

MOVING INFORMATION & DIRECTIONS

WELCOME TO HUDSON HOUSE

Townline Property Management is here to make your move into Hudson House as smooth as possible. Before moving into Hudson House, please make sure that the following steps have been completed:

- ✓ You have an executed Tenancy Agreement
- ✓ Your damage deposit has been paid
- ✓ Your account with Livly has been completed
- ✓ You have booked and completed your pre-move in inspection
- ✓ You have booked an approved slot for the elevator on the day you are moving in
- ✓ You have uploaded a copy of your tenant's insurance to your Livly account
- ✓ You have opened a BC Hydro account starting on the day your lease commences

Once the above has been completed you will be able to move into Hudson House.

On the day of your move, please ensure you and your moving crew/company arrive at the building **on time**, so you can make the most of your allowed time with the booked elevator. Remember that once your booked move in time has expired, you will not be able to use the elevator as the next in line will have the use of it. **If you are using a moving company, please make sure they are aware of this policy.**

The entrance to the Hudson House loading bay is through Herald Street, please see below diagram:

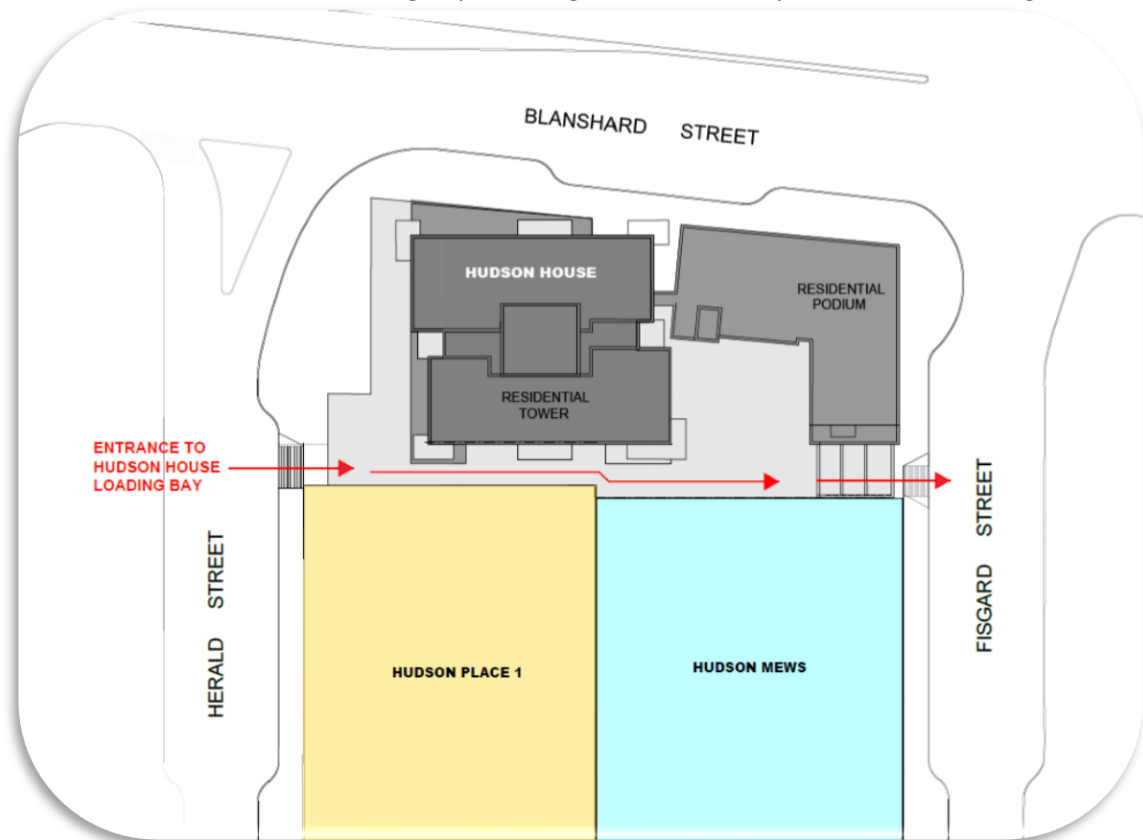

HUDSON HOUSE

Please note that the loading bay lane way is a **one-way** lane way and exits onto Fisgard Street, per the previous diagram. Below you will find a second diagram showing where the loading bay stalls are located, and the route towards the tower elevators (in blue) or the podium elevators (in yellow).

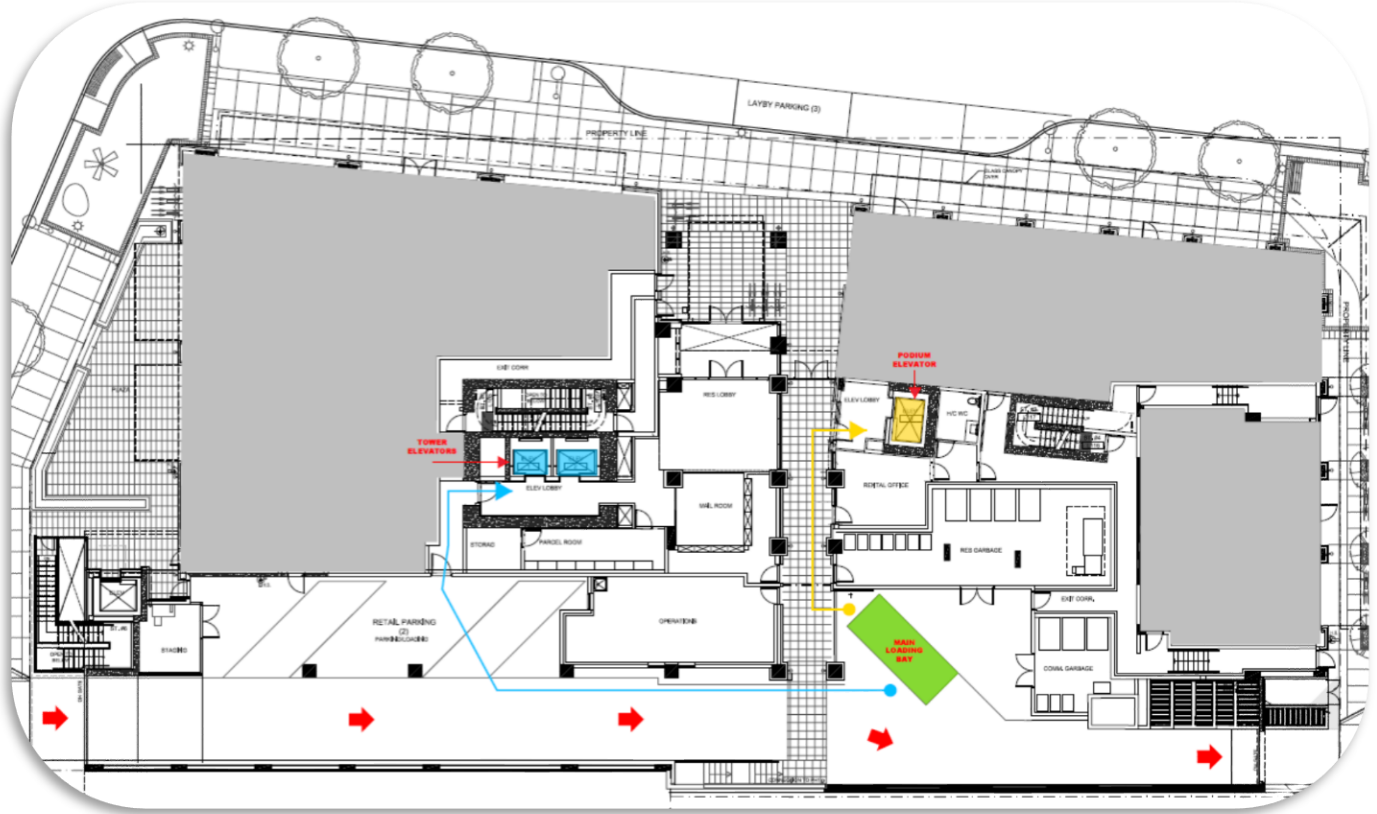

Please take note of the following details regarding the loading bay:

- Highlighted in green the loading bay stall has a dimension of: 20 feet long by 8 feet wide. This will allow you to park a 20' moving truck maximum. Anything larger will not fit.
- The height clearance of the loading bay is 13 feet.

We would also like to remind you that if you have any large deliveries which will not be able to be scheduled at the time you have the elevator booked, to please contact the Resident Manager so it can be managed as best as we can. Please understand that these types of deliveries might not be able to be accommodated at the time of delivery and wait times to use the elevator may be needed. We will do our best to accommodate those.

We appreciate you taking the time to review these instructions.

Thank you

Hudson House Management Team